



Polar Series AUTOTEST

The most minimalist emergency light with Autotest function: a microprocessor checks the status of the emergency LEDs, the battery and the electronics on a regular basis. Light consisting of 6 white LEDs (5,700 K or 3,000 K) in the shape of a crown. Set consisting of luminaire module, kit module and battery. Remote controllable.



Non-maintained

model	Φ (lm)	A (h)	P net (W)	RRP (€)
MBA-300-BT	300	1	2.0	101.80
MBA-200-BT	200	1	1.5	95.24
MBA-200-2-BT	200	2	2.0	98.08
MBA-150-3-BT	150	3	2.0	98.08

To request different body finish and/or diffuser type, change the corresponding letters in the reference. To request a colour temperature of 3,000 K, add "W" to the reference. To request IP55 degree of protection, add "E" at the end of the reference. Example:

White B	Body	T° colour	5,700 K
Anthracite A			
(+4.38 €) Graphite G			
(+4.38 €) Matt chrome C			
MBA-200-BTWE			W 3,000 K
Transparent T	Diffuser		
(-8%) Soft opal S			
IP42	Protection		
(+12.02 €) IP55 E			

◇ Ni-Cd (HT) battery.

◇ Information about Autotest on page 85.

◇ Interdistances on page 84.

Maintained

model	Φ (lm)	A (h)	P net (W)	RRP (€)
MBA-300P-BT	300	1	6.5	114.68
MBA-200P-BT	200	1	4.0	108.03
MBA-200P-2-BT	200	2	4.5	110.97
MBA-150P-3-BT	150	3	3.7	110.97

Flush mounting

Luminaire module

Cut: Ø55 mm

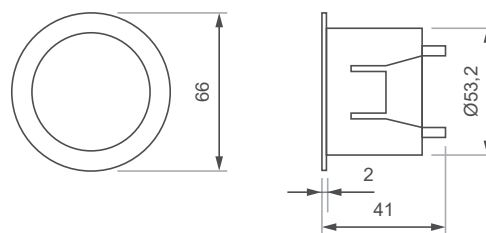

Kit module

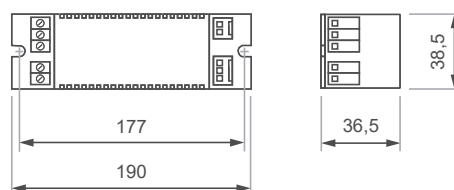

Battery module

